

# D1G – DRUVA®TEC LINE REGULATOR

## LINE REGULATOR | TEC LINE (BRASS) | 250 M<sup>3</sup> SERIES | SINGLE STAGE



Line regulators of this type are suitable to reduce a high supply pressure through different pressure stages. They can be used in supply systems of inert, flammable and oxidising gases with a purity of max 4.5. Their use for acetylene, corrosive or toxic gases is not possible.

### SPECIAL FEATURES:

- > Hybrid design to incorporate both a dome and pilot regulator into a single unit
- > Compact design
- > Excellent pressure adjustment



TECHNICAL DATA	
<b>Operating temperature range:</b>	-20 °C to +60 °C
<b>Inlet / outlet ports:</b>	NPT 3/4" female
<b>Nominal Inlet Pressure:</b>	200 bar
<b>Delivery pressure range:</b>	4 bar up to 38 bar adjustable
<b>Outlet Pressure Rise:</b>	1 psig per 100 psig decay of inlet pressure
<b>Leakage rate to atmosphere:</b>	max. 10 cm <sup>3</sup> /h
<b>Leakage across seat:</b>	no leakage by bubble test (p1=200 bar; 5 min)
<b>Flow Coefficient (Cv):</b>	1,02
<b>Weight:</b>	2,050 kg (no inlet and outlet connections)
<b>Material gas wetted parts:</b>	
<b>Regulator body:</b>	Brass
<b>Dome Cap:</b>	Brass
<b>Pilot Diaphragm:</b>	Neoprene
<b>Dome Piston:</b>	Brass
<b>Nozzles/Seat Holders (Pilot/Dome):</b>	Brass
<b>Seat Stems (Pilot &amp; Dome):</b>	Stainless Steel type 303
<b>Seats:</b>	Dome Seat Viton®, Pilot Seat Urethane
<b>Seals/Piston O- Ring:</b>	Viton®
<b>Dome Seat Backup Ring:</b>	Teflon®
<b>Seat Return Springs:</b>	Stainless Steel Type 302
<b>Inlet Filter Regulator:</b>	50 µm Sintered Bronze, Electroless Nickel Plated
<b>Material Bracket:</b>	Stainless Steel Type 304
<b>H.P. Gauge 50 mm Diameter</b>	315 bar / 4568 psi (ISO 5171)
<b>L.P. Gauge 50 mm Diameter</b>	46 bar / 667 psi (ISO 5171)
<b>Adjustment and Testing during Manufacturing:</b>	- Test Pressure: 2000±100 psig Inlet (Oil-free Air or Dry Nitrogen) - Test Gun on Outlet With 0.0635" Orifice Installed
<b>Max. Delivery Setting (Flowing):</b>	38 bar- 41 bar (550-600 psig)
<b>Pressure Drop Allowance:</b>	20 psig Max. with Regulator Set at 200 psig (During Full Open/Close of Test Gun)
<b>Initial Shutoff Allowance:</b>	5 psig creep allowed in the First one (1) Minute, no additional creep allowed in the following four minutes

### ORDER CODE:

Item number	Description
<b>0782-4426</b>	D1G-550-12F-12F
<i>D1G - type</i> <i>550 - delivery pressure range 550 psi (38 bar)</i> <i>12F - Inlet Port NPT ¾" f</i> <i>12F - Outlet Port NPT ¾" f</i>	

TECHNICAL DRAWING:

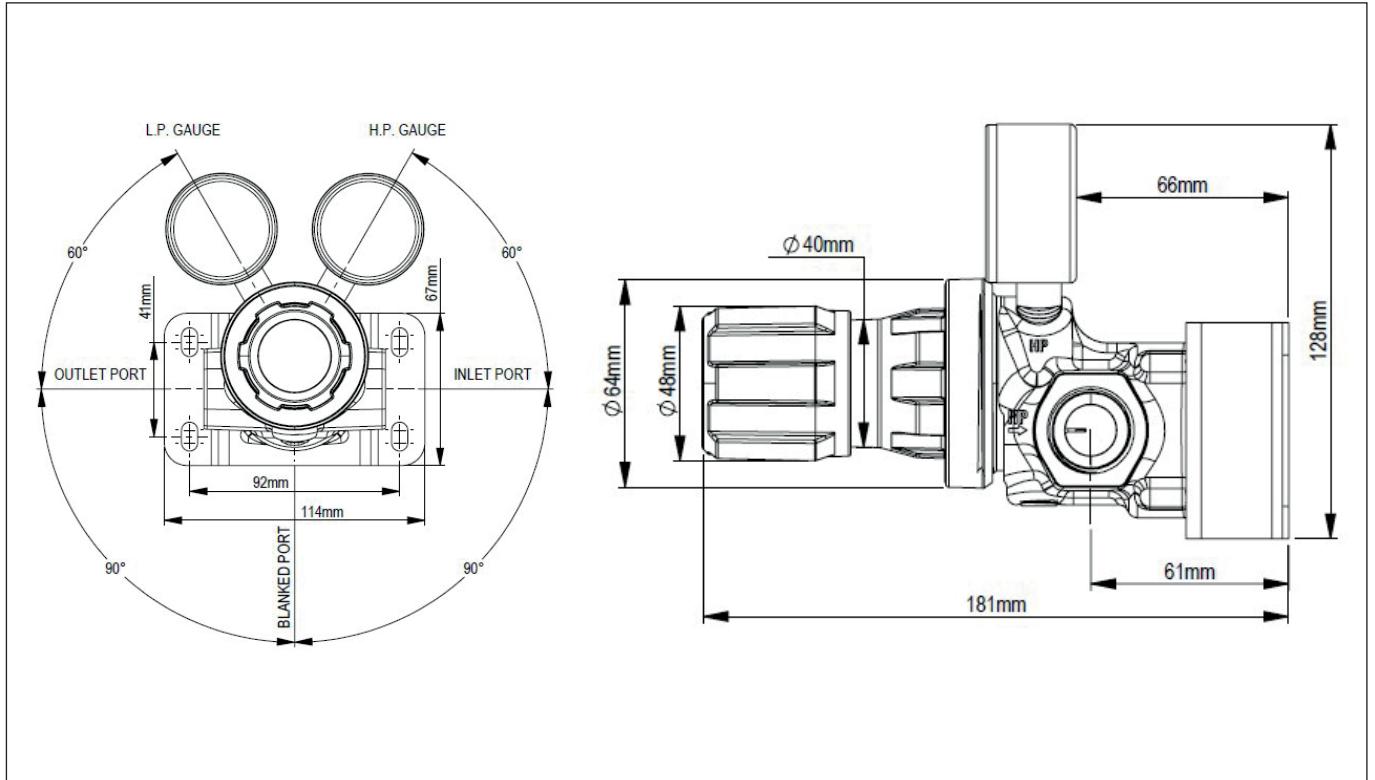

FLOW CURVE:

**D1G Flow Performance**  
**P2= 38 bar**

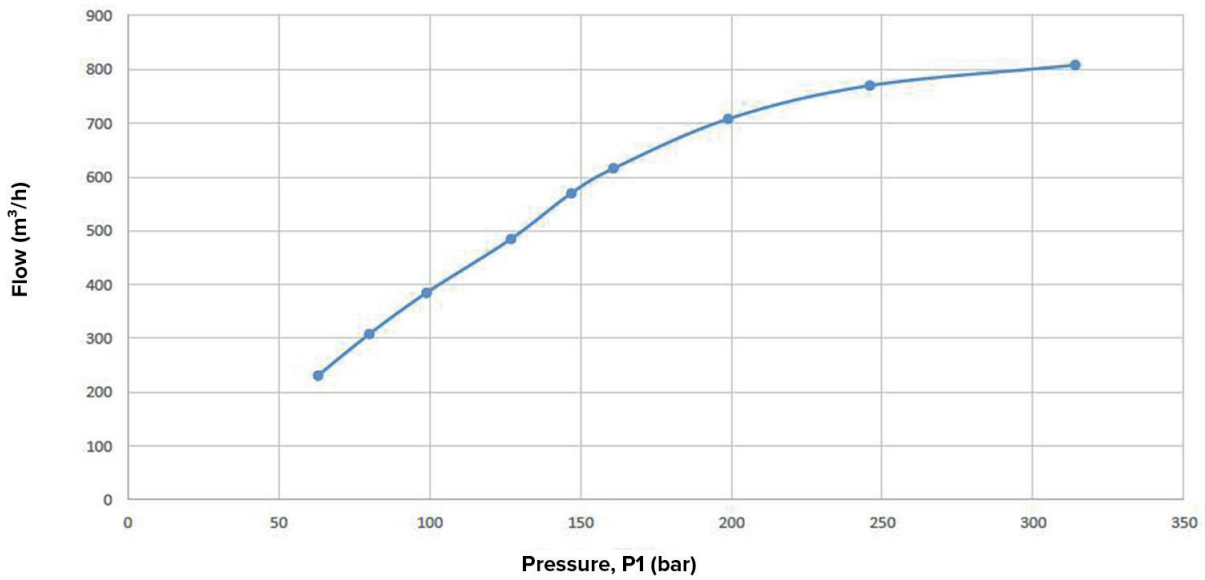

FLOW PERFORMANCE

**Flow Performance**

**31 bar Inlet Pressure (Air @ 21°C)**

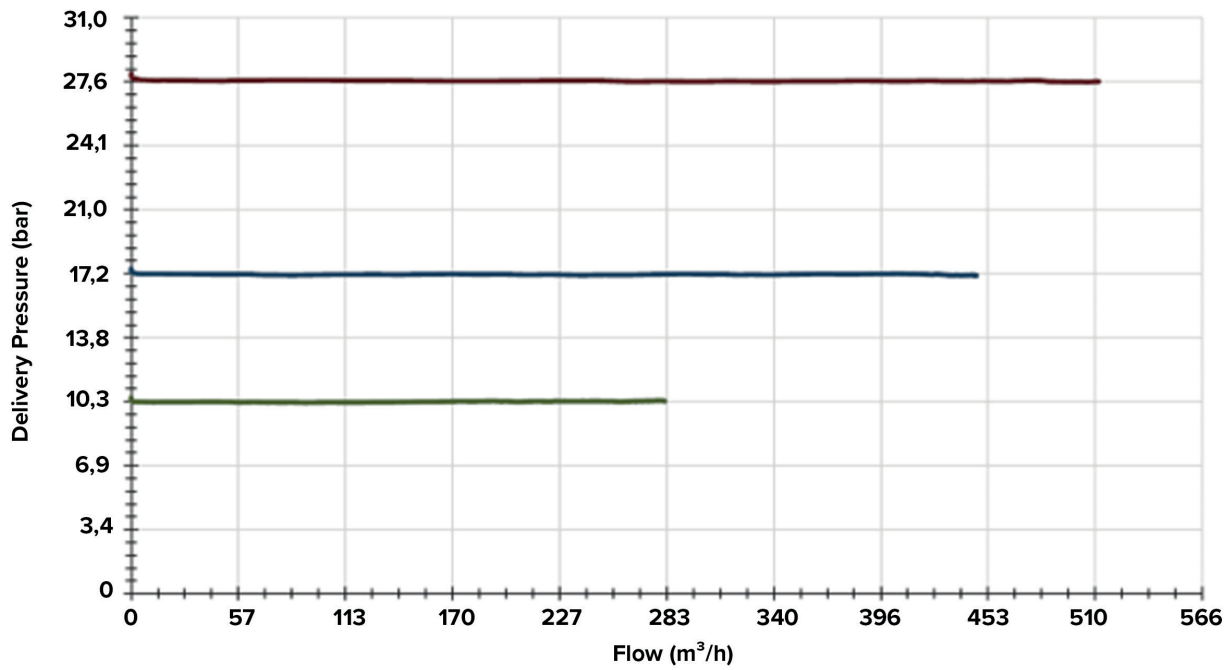

**Flow Performance**

**69 bar Inlet Pressure (Air @ 21°C)**

